

WEST SUSSEX COUNTY COUNCIL
((ADUR DISTRICT) (PARKING PLACES & TRAFFIC REGULATION)
(CONSOLIDATION) ORDER 2009)
(SHOREHAM ACADEMY AMENDMENT) ORDER 2014

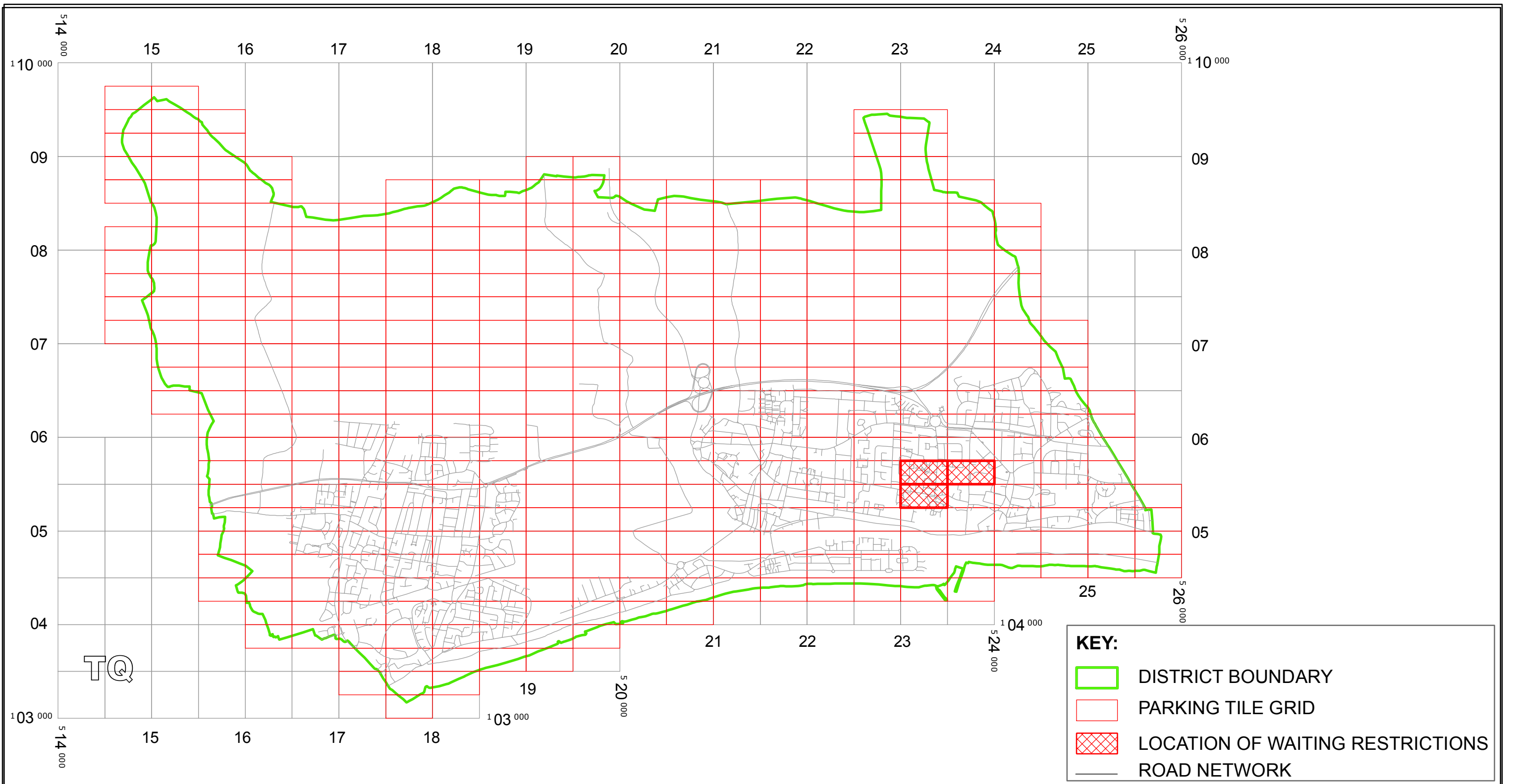

West Sussex County Council
 Infrastructure
 The Grange
 Tower Street
 Chichester
 West Sussex
 PO19 1RH

WEST SUSSEX COUNTY COUNCIL
 ((ADUR DISTRICT) (PARKING PLACES & TRAFFIC REGULATION) (CONSOLIDATION) ORDER 2009)
 (SHOREHAM ACADEMY AMENDMENT) ORDER 2014

LOCATION OF WAITING RESTRICTIONS

Reproduced from or based upon 2010 Ordnance Survey mapping with permission of the Controller of HMSO (c)
 Crown Copyright reserved. Unauthorised reproduction infringes Crown copyright and may lead to prosecution or
 civil proceedings West Sussex County Council Licence No. 100023447



SCALE: 1:40 000
 DATE: 28/04/2014

Key for Waiting Restrictions

All areas over which the provision of the orders apply are defined by the shaded areas as shown on the following plans plus a contiguous area not indicated on the plans of verge and/or footway between the carriageway edge and the highway boundary. The plans in this schedule are based upon grid references of the Ordnance Survey National Grid defined by the OSGB 36 triangulation.

Prohibition of waiting at any time

101  check No waiting at any time

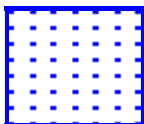
112  dot5 No waiting 8.00am-6.00pm Mon-Fri

Clearways

1106  rice1 School Keep Clear No stopping 8.00am-6.00pm Mon-Fri

WEST SUSSEX COUNTY COUNCIL
((ADUR DISTRICT) (PARKING PLACES AND TRAFFIC REGULATION)
(CONSOLIDATION) ORDER 2009)
(SHOREHAM ACADEMY AMENDMENT) ORDER 2014

West Sussex County Council in exercise of their powers under Sections 1 (1) 2 (1) and (2), 4 (2), 45, 46, 49 and 53 and Part IV of Schedule 9 of the Road Traffic Regulation Act 1984 "the Act" as amended and of all other enabling powers and after consultation with the chief officer of police in accordance with Part III of Schedule 9 to the Act hereby make the following Order:-

1. This Order shall come into operation on the 28TH day of April 2014 and may be cited as "West Sussex County Council ((Adur District) (Parking Places and Traffic Regulation) (Consolidation) Order 2009) (Shoreham Academy Amendment) Order 2014."
2. The "West Sussex County Council (Adur District) (Parking Places and Traffic Regulation) (Consolidation) Order 2009" is hereby amended by the deletion from it of the plans specified in the First Schedule to this Order, the substitution of the plans attached in the Second Schedule to this Order and the insertion of the Plan attached in the Third Schedule.

FIRST SCHEDULE
Plan numbers to be revoked

TQ2305NWS (Issue No. 1)
TQ2305SWN (Issue No. 1)

SECOND SCHEDULE
Plans to be substituted
(as attached)

TQ2305NWS (Issue No. 2)
TQ2305SWN (Issue No. 2)

THIRD SCHEDULE
Plan to be inserted
(as attached)

TQ2305NES (Issue No. 1)

The COMMON SEAL of WEST SUSSEX)
COUNTY COUNCIL was hereto affixed)
the TWENTY SECOND day of APRIL 2014)
in the presence of) (L.S.)

N. M. M. M. M.)
Authorized Signatory)
I HEREBY CERTIFY THIS TO)
BE A TRUE COPY OF THE)
ORIGINAL DOCUMENT)

Tom Kenshaw)
Authorized Officer)
WEST SUSSEX COUNTY COUNCIL)



OFFER DELEGATED AUTHORITY

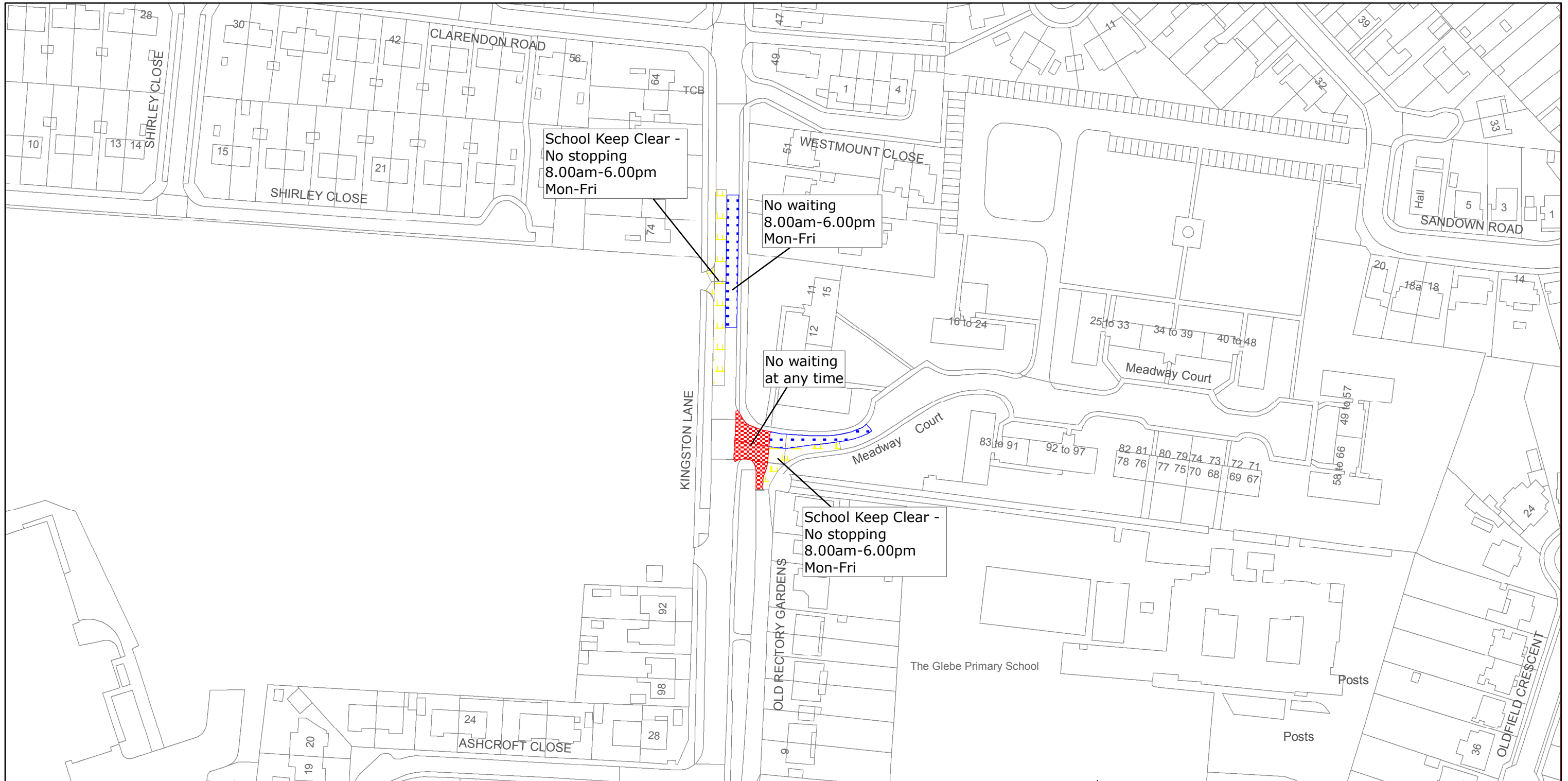

West Sussex County Council
 Highways & Transport
 The Grange
 Tower Street
 Chichester
 West Sussex
 PO19 1RH

ADUR DISTRICT: SHOREHAM/SOUTHWICK

WAITING RESTRICTIONS

TILE REF NO:
 TQ2305NES

SHEET ISSUE NO 1
 SHEET ACTIVE FROM - 28/04/2014



SCALE:
 1:1250
 at A3 size

Reproduced from or based upon 2010 Ordnance Survey mapping with permission of the Controller of HMSO (c) Crown Copyright reserved.
 Unauthorised reproduction infringes Crown copyright and may lead to prosecution or civil proceedings West Sussex County Council Licence No. 100018485

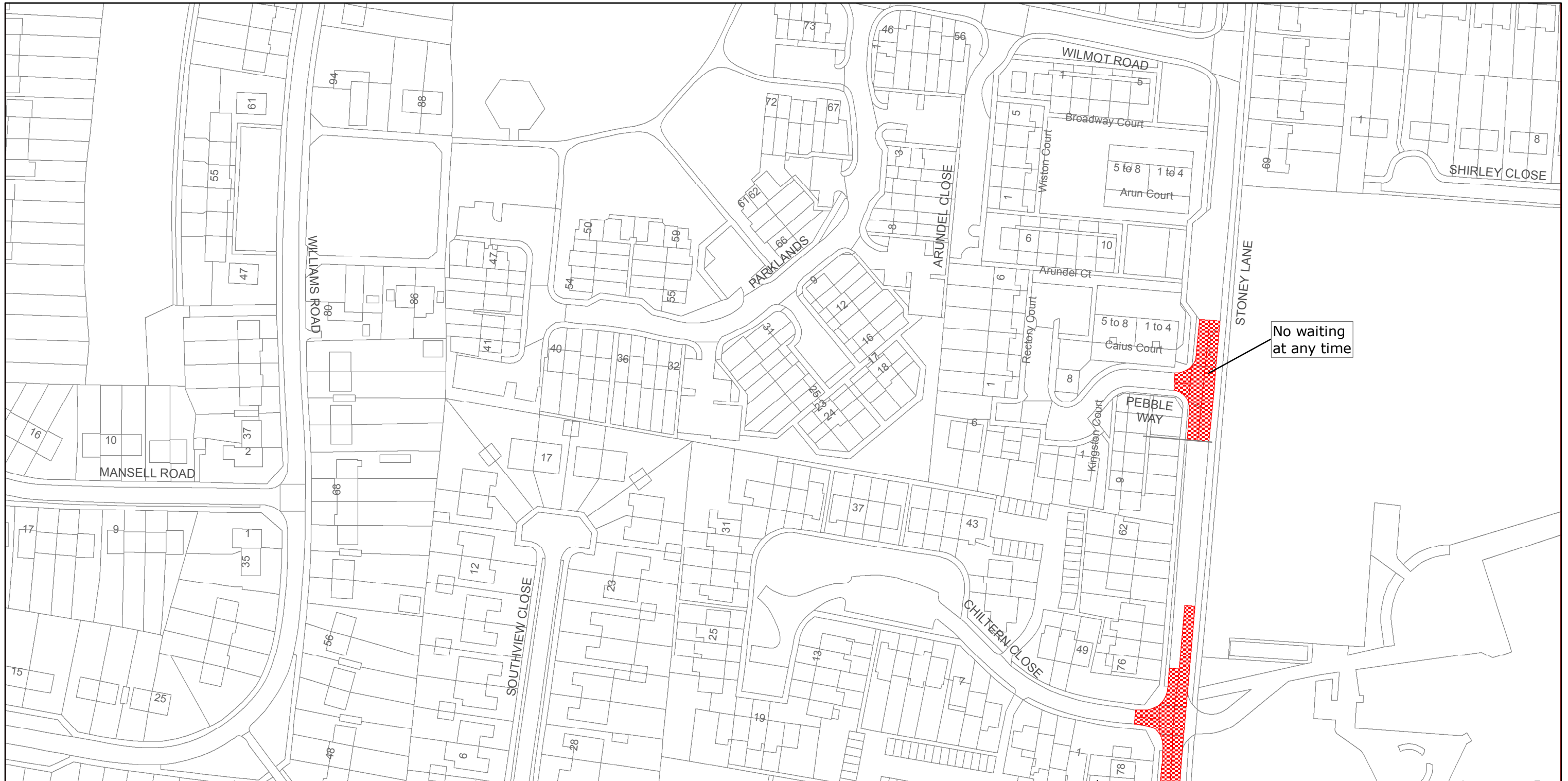

West Sussex County Council
 Highways & Transport
 The Grange
 Tower Street
 Chichester
 West Sussex
 PO19 1RH

ADUR DISTRICT: SHOREHAM/SOUTHWICK

WAITING RESTRICTIONS

**TILE REF NO:
 TQ2305NWS**

SHEET ISSUE NO 2
 SHEET ACTIVE FROM - 28/04/2014



SCALE:
 1:1250
 at A3 size

Reproduced from or based upon 2010 Ordnance Survey mapping with permission of the Controller of HMSO (c) Crown Copyright reserved.
 Unauthorised reproduction infringes Crown copyright and may lead to prosecution or civil proceedings West Sussex County Council Licence No. 100018485

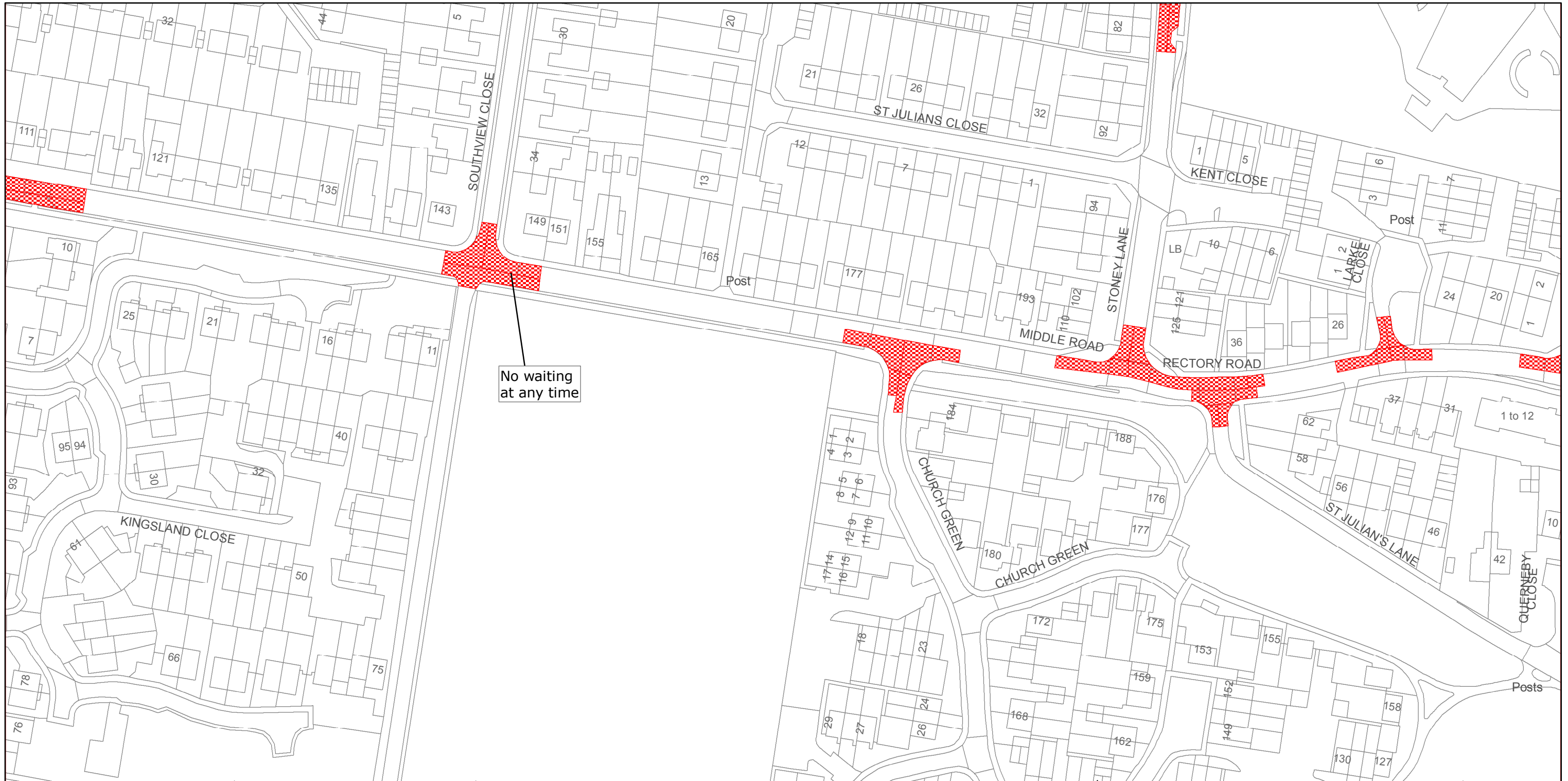

No waiting
at any time



West Sussex County Council
Highways & Transport
The Grange
Tower Street
Chichester
West Sussex
PO19 1RH

ADUR DISTRICT: SHOREHAM/SOUTHWICK

WAITING RESTRICTIONS

TILE REF NO:
TQ2305SWN

SHEET ISSUE NO 2
SHEET ACTIVE FROM - 28/04/2014



SCALE:
1:1250
at A3 size

Reproduced from or based upon 2010 Ordnance Survey mapping with permission of the Controller of HMSO (c) Crown Copyright reserved.
Unauthorised reproduction infringes Crown copyright and may lead to prosecution or civil proceedings West Sussex County Council Licence No. 100018485